

# Atlantic 605

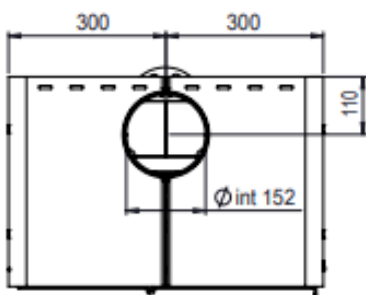
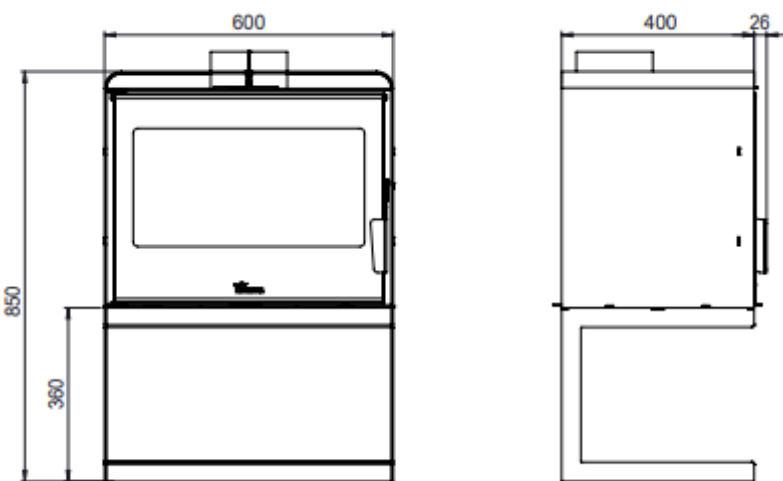

## ATLANTIC 605

ATLANTIC RANGE

NOMINAL OUTPUT **10 kW**      EFFICIENCY **77 %**

### DESCRIPTION

### TECHNICAL CHARACTERISTICS

### OPTIONS

CO EMISSION	0.11 %
CAPABLE OF HEATING	222 m <sup>2</sup>
SIZE (width x height x depth)	600 x 850 x 400 mm
FLUE SOCKET	∅ 150 mm
LOG SIZE	50 cm
WEIGHT	90 Kg

### CERTIFICADOS ENERGÉTICOS



**MADE IN SPAIN**